

Appendix B

Traffic Analysis Supporting Data for Existing System Analysis

5: US 14 & 270th Avenue Performance by approach

Approach	WB	NB	SB	All
Denied Del/Veh (s)	0.0	0.0	0.1	0.0
Total Del/Veh (s)	4.4	6.1	8.8	4.6

7: US 14 Performance by approach

Approach	WB	NE	All
Denied Del/Veh (s)	0.0	0.0	0.0
Total Del/Veh (s)	7.7	4.8	5.7

10: 270th Avenue & US 14 Performance by approach

Approach	EB	NB	SB	All
Denied Del/Veh (s)	0.0	0.1	0.0	0.0
Total Del/Veh (s)	4.2	10.2	9.2	4.6

15: 280th Avenue & CR 34 Performance by approach

Approach	EB	NB	SB	All
Denied Del/Veh (s)	0.2	0.0	0.1	0.1
Total Del/Veh (s)	3.5	1.1	1.4	2.6

20: US 14 & 280th Avenue Performance by approach

Approach	WB	NB	SB	All
Denied Del/Veh (s)	0.0	0.0	0.0	0.0
Total Del/Veh (s)	3.9	4.9	7.4	4.6

21: US 14 Performance by approach

Approach	EB	WB	All
Denied Del/Veh (s)	0.0	0.0	0.0
Total Del/Veh (s)	12.2	3.1	9.7

25: 280th Avenue & US 14 Performance by approach

Approach	EB	NB	SB	All
Denied Del/Veh (s)	0.0	0.1	0.0	0.0
Total Del/Veh (s)	5.7	8.8	7.4	5.9

30: 2nd Avenue & Frontage Rd Performance by approach

Approach	EB	WB	NB	SB	All
Denied Del/Veh (s)	0.1	0.9	0.0	0.3	0.2
Total Del/Veh (s)	58.7	34.8	2.7	86.7	47.3

33: US 14 & 260th Avenue Performance by approach

Approach	WB	NB	SB	All
Denied Del/Veh (s)	0.0	0.0	0.1	0.0
Total Del/Veh (s)	4.1	3.6	2.0	4.1

34: 260th Avenue & US 14 Performance by approach

Approach	EB	NB	All
Denied Del/Veh (s)	0.2	0.1	0.2
Total Del/Veh (s)	1.3	9.3	1.3

35: 2nd Avenue & US 14 Performance by approach

Approach	EB	WB	NB	SB	All
Denied Del/Veh (s)	0.0	0.0	0.8	0.1	0.0
Total Del/Veh (s)	29.6	34.5	34.2	18.6	29.5

40: 10th Avenue & US 14 Performance by approach

Approach	EB	WB	NB	SB	All
Denied Del/Veh (s)	0.0	0.0	0.3	0.6	0.1
Total Del/Veh (s)	56.0	22.9	52.2	37.3	44.1

45: US 14 & CR 3 Performance by approach

Approach	WB	NB	SB	All
Denied Del/Veh (s)	0.0	0.0	0.1	0.0
Total Del/Veh (s)	9.5	4.8	13.3	9.7

50: CR 3 & US 14 Performance by approach

Approach	EB	NB	SB	All
Denied Del/Veh (s)	0.0	0.1	0.0	0.0
Total Del/Veh (s)	5.0	27.7	24.5	6.1

55: US 14 & CR 104 Performance by approach

Approach	WB	NB	SB	All
Denied Del/Veh (s)	0.0	0.0	0.2	0.0
Total Del/Veh (s)	1.5	7.6	11.1	3.1

60: CR 104 & US 14 Performance by approach

Approach	EB	NB	SB	All
Denied Del/Veh (s)	0.0	0.1	0.0	0.0
Total Del/Veh (s)	17.1	53.6	30.8	18.1

65: US 14 Performance by approach

Approach	WB	NB	All
Denied Del/Veh (s)	0.2	0.0	0.2
Total Del/Veh (s)	1.4	6.1	1.6

70: 7th Street & US 14 Performance by approach

Approach	EB	NB	SB	All
Denied Del/Veh (s)	0.0	0.1	0.0	0.0
Total Del/Veh (s)	2.9	32.0	28.8	4.2

Total Network Performance

Denied Del/Veh (s)	0.3
Total Del/Veh (s)	89.4

Intersection: 5: US 14 & 270th Avenue

Movement	NB	SB
Directions Served	LT	TR
Maximum Queue (ft)	30	27
Average Queue (ft)	6	8
95th Queue (ft)	26	22
Link Distance (ft)	77	1184
Upstream Blk Time (%)		
Queuing Penalty (veh)		
Storage Bay Dist (ft)		
Storage Blk Time (%)		
Queuing Penalty (veh)		

Intersection: 7: US 14

Movement		
Directions Served		
Maximum Queue (ft)		
Average Queue (ft)		
95th Queue (ft)		
Link Distance (ft)		
Upstream Blk Time (%)		
Queuing Penalty (veh)		
Storage Bay Dist (ft)		
Storage Blk Time (%)		
Queuing Penalty (veh)		

Intersection: 10: 270th Avenue & US 14

Movement	NB	SB
Directions Served	TR	LT
Maximum Queue (ft)	61	42
Average Queue (ft)	18	13
95th Queue (ft)	41	38
Link Distance (ft)	1408	77
Upstream Blk Time (%)		
Queuing Penalty (veh)		
Storage Bay Dist (ft)		
Storage Blk Time (%)		
Queuing Penalty (veh)		

Intersection: 15: 280th Avenue & CR 34

Movement	EB	NB
Directions Served	LR	LT
Maximum Queue (ft)	64	18
Average Queue (ft)	33	1
95th Queue (ft)	52	9
Link Distance (ft)	4604	88
Upstream Blk Time (%)		
Queuing Penalty (veh)		
Storage Bay Dist (ft)		
Storage Blk Time (%)		
Queuing Penalty (veh)		

Intersection: 20: US 14 & 280th Avenue

Movement	WB	NB	SB
Directions Served	R	LT	TR
Maximum Queue (ft)	4	45	86
Average Queue (ft)	0	9	37
95th Queue (ft)	3	32	67
Link Distance (ft)		65	88
Upstream Blk Time (%)		0	0
Queuing Penalty (veh)		0	0
Storage Bay Dist (ft)	450		
Storage Blk Time (%)			
Queuing Penalty (veh)			

Intersection: 21: US 14

Movement
Directions Served
Maximum Queue (ft)
Average Queue (ft)
95th Queue (ft)
Link Distance (ft)
Upstream Blk Time (%)
Queuing Penalty (veh)
Storage Bay Dist (ft)
Storage Blk Time (%)
Queuing Penalty (veh)

Intersection: 25: 280th Avenue & US 14

Movement	NB	SB
Directions Served	TR	LT
Maximum Queue (ft)	20	75
Average Queue (ft)	3	36
95th Queue (ft)	14	67
Link Distance (ft)	1754	65
Upstream Blk Time (%)		1
Queuing Penalty (veh)		1
Storage Bay Dist (ft)		
Storage Blk Time (%)		
Queuing Penalty (veh)		

Intersection: 30: 2nd Avenue & Frontage Rd

Movement	EB	WB	WB	NB	SB
Directions Served	LTR	L	TR	LTR	LTR
Maximum Queue (ft)	126	77	108	44	719
Average Queue (ft)	44	19	40	17	341
95th Queue (ft)	96	57	84	42	721
Link Distance (ft)	1224		1041	27	1932
Upstream Blk Time (%)				15	
Queuing Penalty (veh)				49	
Storage Bay Dist (ft)		140			
Storage Blk Time (%)			0		
Queuing Penalty (veh)			0		

Intersection: 33: US 14 & 260th Avenue

Movement	NB	SB
Directions Served	LT	TR
Maximum Queue (ft)	18	12
Average Queue (ft)	0	1
95th Queue (ft)	6	6
Link Distance (ft)	48	1107
Upstream Blk Time (%)	0	
Queuing Penalty (veh)	0	
Storage Bay Dist (ft)		
Storage Blk Time (%)		
Queuing Penalty (veh)		

Intersection: 34: 260th Avenue & US 14

Movement	NB
Directions Served	TR
Maximum Queue (ft)	26
Average Queue (ft)	2
95th Queue (ft)	13
Link Distance (ft)	1213
Upstream Blk Time (%)	
Queuing Penalty (veh)	
Storage Bay Dist (ft)	
Storage Blk Time (%)	
Queuing Penalty (veh)	

Intersection: 35: 2nd Avenue & US 14

Movement	EB	EB	EB	EB	WB	WB	WB	WB	NB	NB	SB	SB
Directions Served	L	T	T	R	L	T	T	R	LT	R	LT	R
Maximum Queue (ft)	253	393	408	23	38	319	319	192	115	50	94	45
Average Queue (ft)	116	217	225	4	9	124	133	49	38	7	69	11
95th Queue (ft)	220	353	367	15	27	256	259	129	90	31	91	35
Link Distance (ft)		3308	3308			5187	5187		2406		27	27
Upstream Blk Time (%)											69	2
Queuing Penalty (veh)											134	4
Storage Bay Dist (ft)	475			475	450			450		100		
Storage Blk Time (%)		0	0			0			1			
Queuing Penalty (veh)		0	0			0			0			

Intersection: 40: 10th Avenue & US 14

Movement	EB	EB	EB	EB	WB	WB	WB	WB	NB	NB	SB	SB
Directions Served	L	T	T	R	L	T	T	R	LT	R	L	LT
Maximum Queue (ft)	206	712	721	150	30	289	304	75	210	89	239	277
Average Queue (ft)	33	391	404	7	5	127	140	20	95	6	133	159
95th Queue (ft)	132	666	681	101	19	232	239	47	177	40	204	232
Link Distance (ft)		5187	5187			2001	2001		2853			2081
Upstream Blk Time (%)												
Queuing Penalty (veh)												
Storage Bay Dist (ft)	500			500	525			525		75	180	
Storage Blk Time (%)		6	7						19		2	5
Queuing Penalty (veh)		2	1						1		5	13

Intersection: 40: 10th Avenue & US 14

Movement	SB
Directions Served	R
Maximum Queue (ft)	46
Average Queue (ft)	14
95th Queue (ft)	34
Link Distance (ft)	
Upstream Blk Time (%)	
Queuing Penalty (veh)	
Storage Bay Dist (ft)	180
Storage Blk Time (%)	
Queuing Penalty (veh)	

Intersection: 45: US 14 & CR 3

Movement	WB	WB	WB	NB	SB
Directions Served	L	T	T	LT	TR
Maximum Queue (ft)	14	14	10	43	50
Average Queue (ft)	1	1	0	9	21
95th Queue (ft)	7	10	7	33	38
Link Distance (ft)		13786	13786	33	1474
Upstream Blk Time (%)				1	
Queuing Penalty (veh)				0	
Storage Bay Dist (ft)	540				
Storage Blk Time (%)					
Queuing Penalty (veh)					

Intersection: 50: CR 3 & US 14

Movement	EB	NB	SB
Directions Served	T	TR	LT
Maximum Queue (ft)	4	70	78
Average Queue (ft)	0	20	36
95th Queue (ft)	3	49	67
Link Distance (ft)	3136	2264	33
Upstream Blk Time (%)			30
Queuing Penalty (veh)			21
Storage Bay Dist (ft)			
Storage Blk Time (%)			
Queuing Penalty (veh)			

Intersection: 55: US 14 & CR 104

Movement	WB	NB	SB
Directions Served	R	LT	TR
Maximum Queue (ft)	3	70	73
Average Queue (ft)	0	26	18
95th Queue (ft)	2	52	49
Link Distance (ft)		49	1298
Upstream Blk Time (%)		1	
Queuing Penalty (veh)		1	
Storage Bay Dist (ft)	450		
Storage Blk Time (%)			
Queuing Penalty (veh)			

Intersection: 60: CR 104 & US 14

Movement	NB	SB
Directions Served	TR	LT
Maximum Queue (ft)	76	74
Average Queue (ft)	12	24
95th Queue (ft)	46	58
Link Distance (ft)	1138	49
Upstream Blk Time (%)		4
Queuing Penalty (veh)		3
Storage Bay Dist (ft)		
Storage Blk Time (%)		
Queuing Penalty (veh)		

Intersection: 65: US 14

Movement	NB
Directions Served	L
Maximum Queue (ft)	51
Average Queue (ft)	18
95th Queue (ft)	45
Link Distance (ft)	58
Upstream Blk Time (%)	0
Queuing Penalty (veh)	0
Storage Bay Dist (ft)	
Storage Blk Time (%)	
Queuing Penalty (veh)	

Intersection: 70: 7th Street & US 14

Movement	NB	SB
Directions Served	TR	T
Maximum Queue (ft)	108	65
Average Queue (ft)	41	17
95th Queue (ft)	84	49
Link Distance (ft)	1327	58
Upstream Blk Time (%)		2
Queuing Penalty (veh)		0
Storage Bay Dist (ft)		
Storage Blk Time (%)		
Queuing Penalty (veh)		

Network Summary

Network wide Queuing Penalty: 237

Map - 11722 - US 14 Corridor Analysis
Volumes

11/03/2020

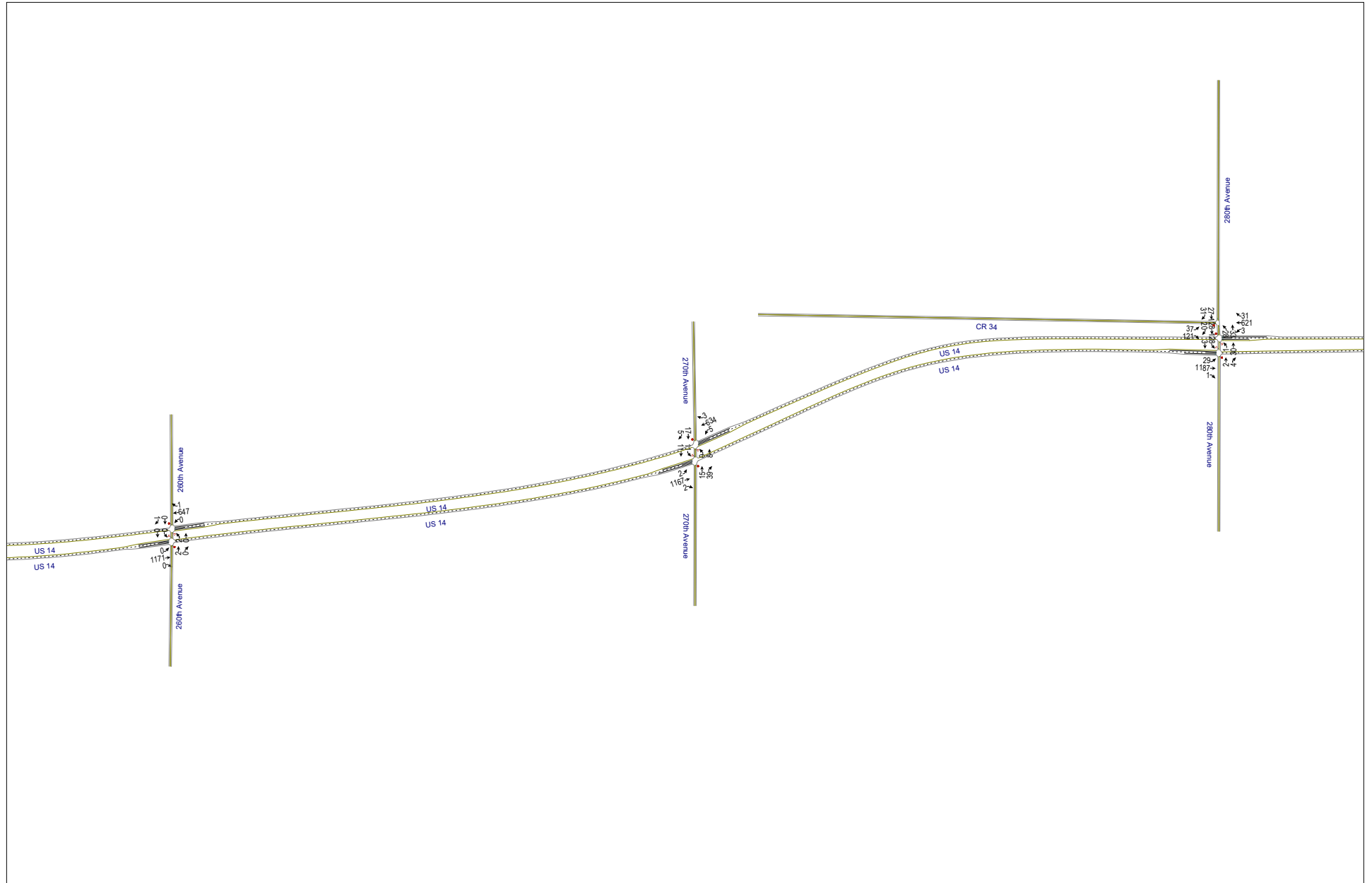

Map - 11722 - US 14 Corridor Analysis
Volumes

11/03/2020

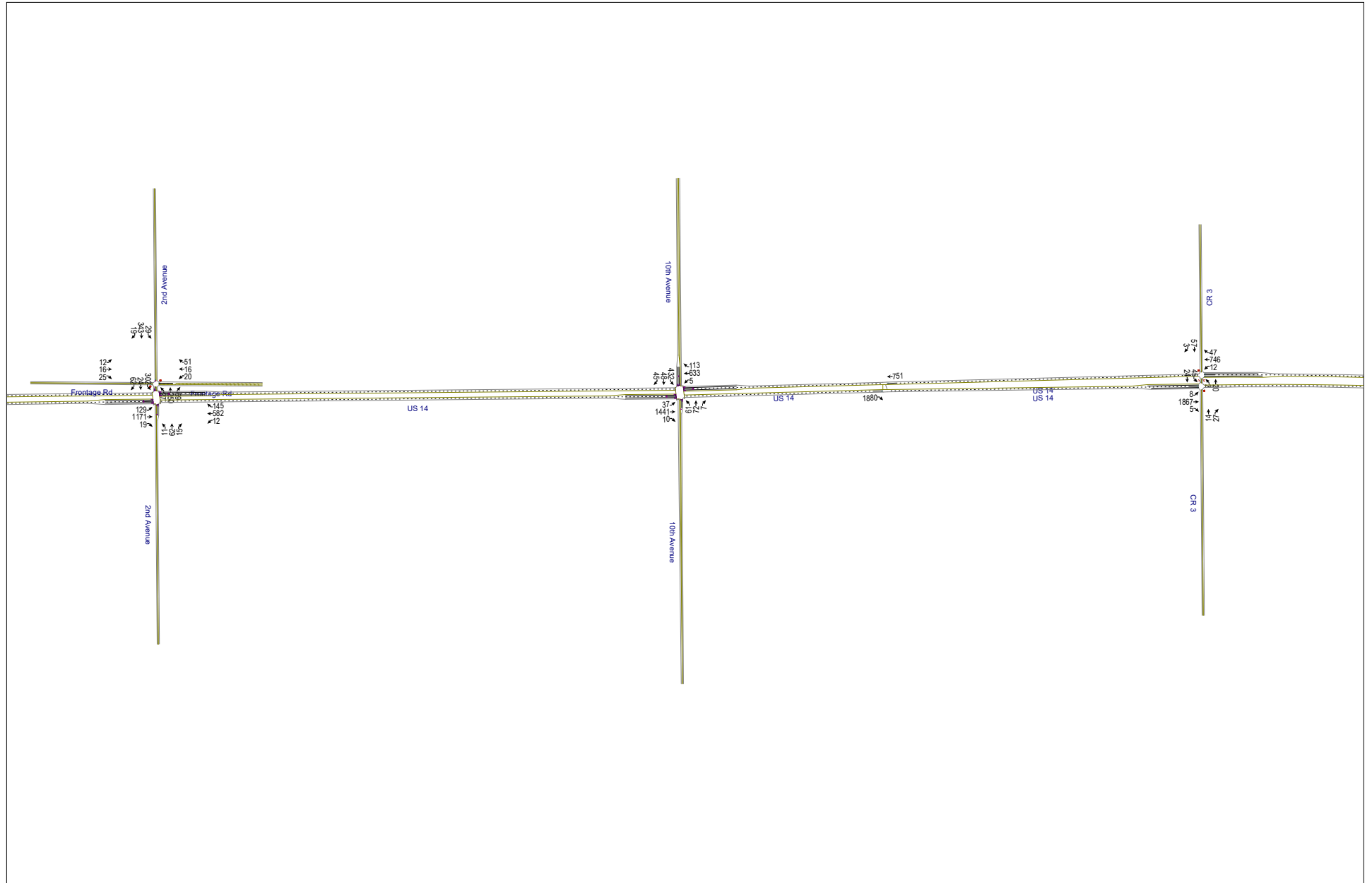

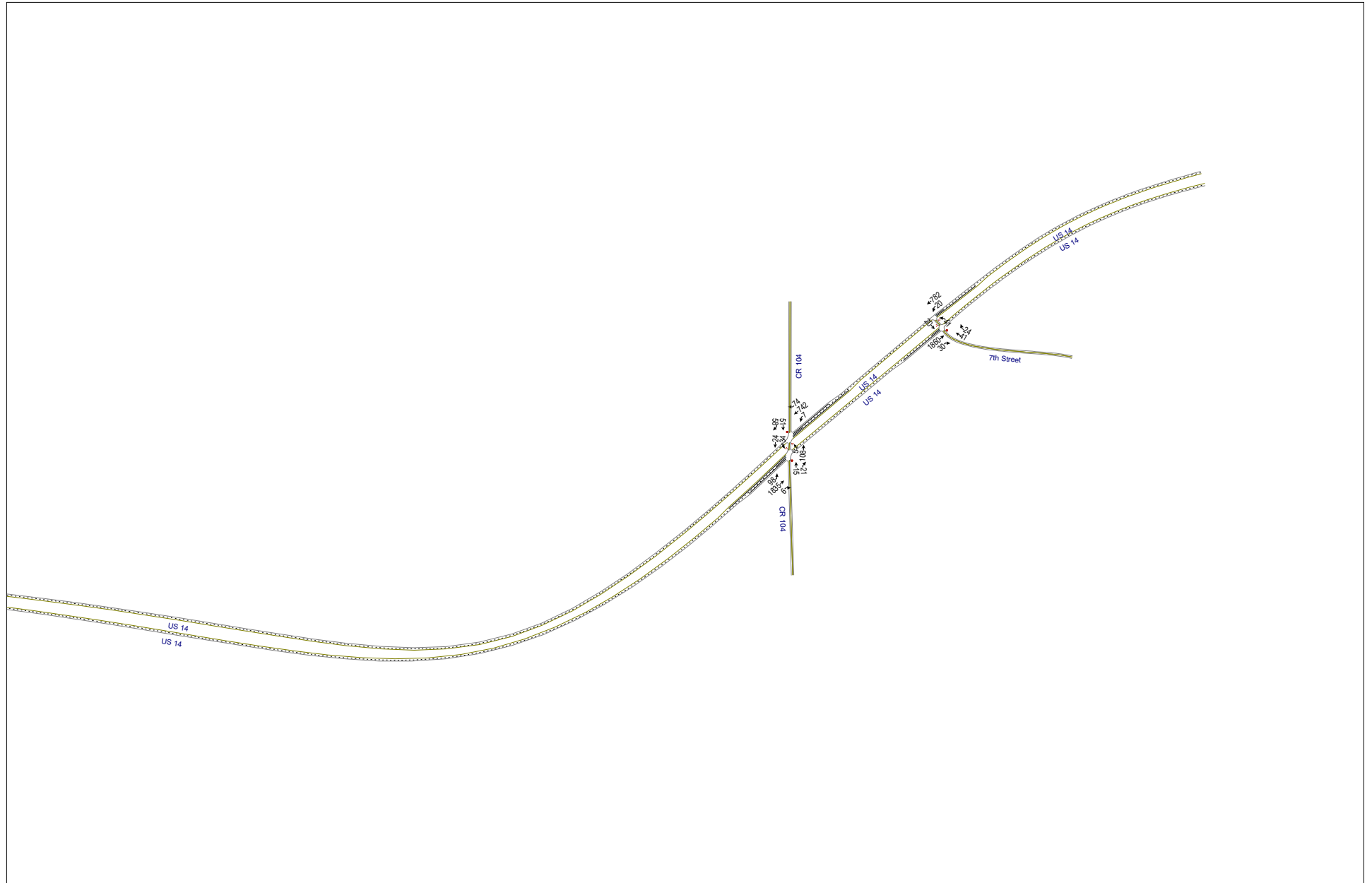

5: US 14 & 270th Avenue Performance by approach

Approach	WB	NB	SB	All
Denied Del/Veh (s)	0.0	0.0	0.1	0.0
Total Del/Veh (s)	5.5	12.3	16.5	5.7

7: US 14 Performance by approach

Approach	WB	NE	All
Denied Del/Veh (s)	0.0	0.0	0.0
Total Del/Veh (s)	12.3	4.3	8.9

10: 270th Avenue & US 14 Performance by approach

Approach	EB	NB	SB	All
Denied Del/Veh (s)	0.0	0.1	0.0	0.0
Total Del/Veh (s)	3.4	7.1	6.3	3.6

15: 280th Avenue & CR 34 Performance by approach

Approach	EB	NB	SB	All
Denied Del/Veh (s)	0.1	0.0	0.1	0.1
Total Del/Veh (s)	4.0	1.1	1.3	1.9

20: US 14 & 280th Avenue Performance by approach

Approach	WB	NB	SB	All
Denied Del/Veh (s)	0.0	0.0	0.0	0.0
Total Del/Veh (s)	6.3	16.8	18.0	6.9

21: US 14 Performance by approach

Approach	EB	WB	All
Denied Del/Veh (s)	0.0	0.0	0.0
Total Del/Veh (s)	8.4	5.1	6.5

25: 280th Avenue & US 14 Performance by approach

Approach	EB	NB	SB	All
Denied Del/Veh (s)	0.0	0.1	0.0	0.0
Total Del/Veh (s)	4.6	9.6	5.7	4.7

30: 2nd Avenue & Frontage Rd Performance by approach

Approach	EB	WB	NB	SB	All
Denied Del/Veh (s)	0.1	1.3	0.0	0.2	0.3
Total Del/Veh (s)	57.3	26.3	1.9	25.3	17.1

33: US 14 & 260th Avenue Performance by approach

Approach	WB	NB	SB	All
Denied Del/Veh (s)	0.0	0.0	0.1	0.0
Total Del/Veh (s)	5.3	13.4	10.9	5.3

34: 260th Avenue & US 14 Performance by approach

Approach	EB	NB	SB	All
Denied Del/Veh (s)	0.2	0.1	0.0	0.2
Total Del/Veh (s)	1.1	7.4	8.5	1.2

35: 2nd Avenue & US 14 Performance by approach

Approach	EB	WB	NB	SB	All
Denied Del/Veh (s)	0.0	0.0	0.6	0.0	0.0
Total Del/Veh (s)	25.2	49.9	40.1	23.8	38.5

40: 10th Avenue & US 14 Performance by approach

Approach	EB	WB	NB	SB	All
Denied Del/Veh (s)	0.0	0.0	0.3	0.7	0.1
Total Del/Veh (s)	33.3	40.9	48.6	40.7	38.9

45: US 14 & CR 3 Performance by approach

Approach	WB	NB	SB	All
Denied Del/Veh (s)	0.0	0.0	0.1	0.0
Total Del/Veh (s)	17.7	19.8	23.7	17.9

50: CR 3 & US 14 Performance by approach

Approach	EB	NB	SB	All
Denied Del/Veh (s)	0.0	0.1	0.0	0.0
Total Del/Veh (s)	3.6	13.2	11.9	4.3

55: US 14 & CR 104 Performance by approach

Approach	WB	NB	SB	All
Denied Del/Veh (s)	0.0	0.0	0.2	0.0
Total Del/Veh (s)	3.3	65.5	226.0	16.8

60: CR 104 & US 14 Performance by approach

Approach	EB	NB	SB	All
Denied Del/Veh (s)	0.0	0.1	0.0	0.0
Total Del/Veh (s)	14.3	23.4	15.2	14.5

65: US 14 Performance by approach

Approach	WB	NB	All
Denied Del/Veh (s)	0.4	0.0	0.4
Total Del/Veh (s)	3.1	33.0	3.5

70: 7th Street & US 14 Performance by approach

Approach	EB	NB	SB	All
Denied Del/Veh (s)	0.0	0.2	0.0	0.0
Total Del/Veh (s)	2.6	12.3	9.4	3.3

Total Network Performance

Denied Del/Veh (s)	0.4
Total Del/Veh (s)	90.4

Intersection: 5: US 14 & 270th Avenue

Movement	NB	SB
Directions Served	LT	TR
Maximum Queue (ft)	39	21
Average Queue (ft)	7	6
95th Queue (ft)	29	19
Link Distance (ft)	77	1184
Upstream Blk Time (%)		
Queuing Penalty (veh)		
Storage Bay Dist (ft)		
Storage Blk Time (%)		
Queuing Penalty (veh)		

Intersection: 7: US 14

Movement		
Directions Served		
Maximum Queue (ft)		
Average Queue (ft)		
95th Queue (ft)		
Link Distance (ft)		
Upstream Blk Time (%)		
Queuing Penalty (veh)		
Storage Bay Dist (ft)		
Storage Blk Time (%)		
Queuing Penalty (veh)		

Intersection: 10: 270th Avenue & US 14

Movement	NB	SB
Directions Served	TR	LT
Maximum Queue (ft)	28	67
Average Queue (ft)	8	22
95th Queue (ft)	22	51
Link Distance (ft)	1408	77
Upstream Blk Time (%)		0
Queuing Penalty (veh)		0
Storage Bay Dist (ft)		
Storage Blk Time (%)		
Queuing Penalty (veh)		

Intersection: 15: 280th Avenue & CR 34

Movement	EB	NB	SB
Directions Served	LR	LT	TR
Maximum Queue (ft)	64	72	10
Average Queue (ft)	28	12	1
95th Queue (ft)	49	44	7
Link Distance (ft)	4604	88	2412
Upstream Blk Time (%)		0	
Queuing Penalty (veh)		0	
Storage Bay Dist (ft)			
Storage Blk Time (%)			
Queuing Penalty (veh)			

Intersection: 20: US 14 & 280th Avenue

Movement	WB	NB	SB
Directions Served	R	LT	TR
Maximum Queue (ft)	8	45	80
Average Queue (ft)	0	13	31
95th Queue (ft)	5	38	65
Link Distance (ft)		65	88
Upstream Blk Time (%)		0	1
Queuing Penalty (veh)		0	1
Storage Bay Dist (ft)	450		
Storage Blk Time (%)			
Queuing Penalty (veh)			

Intersection: 21: US 14

Movement
Directions Served
Maximum Queue (ft)
Average Queue (ft)
95th Queue (ft)
Link Distance (ft)
Upstream Blk Time (%)
Queuing Penalty (veh)
Storage Bay Dist (ft)
Storage Blk Time (%)
Queuing Penalty (veh)

Intersection: 25: 280th Avenue & US 14

Movement	NB	SB
Directions Served	TR	LT
Maximum Queue (ft)	19	55
Average Queue (ft)	2	21
95th Queue (ft)	12	49
Link Distance (ft)	1754	65
Upstream Blk Time (%)		0
Queuing Penalty (veh)		0
Storage Bay Dist (ft)		
Storage Blk Time (%)		
Queuing Penalty (veh)		

Intersection: 30: 2nd Avenue & Frontage Rd

Movement	EB	WB	WB	NB	SB
Directions Served	LTR	L	TR	LTR	LTR
Maximum Queue (ft)	160	105	135	49	303
Average Queue (ft)	52	34	51	21	132
95th Queue (ft)	141	74	104	46	252
Link Distance (ft)	1224		1041	27	1932
Upstream Blk Time (%)				12	
Queuing Penalty (veh)				48	
Storage Bay Dist (ft)		140			
Storage Blk Time (%)		0	1		
Queuing Penalty (veh)		0	0		

Intersection: 33: US 14 & 260th Avenue

Movement	NB	SB
Directions Served	LT	TR
Maximum Queue (ft)	29	16
Average Queue (ft)	3	1
95th Queue (ft)	17	7
Link Distance (ft)	48	1107
Upstream Blk Time (%)	0	
Queuing Penalty (veh)	0	
Storage Bay Dist (ft)		
Storage Blk Time (%)		
Queuing Penalty (veh)		

Intersection: 34: 260th Avenue & US 14

Movement	NB	SB
Directions Served	TR	LT
Maximum Queue (ft)	26	23
Average Queue (ft)	3	1
95th Queue (ft)	15	11
Link Distance (ft)	1213	48
Upstream Blk Time (%)		0
Queuing Penalty (veh)		0
Storage Bay Dist (ft)		
Storage Blk Time (%)		
Queuing Penalty (veh)		

Intersection: 35: 2nd Avenue & US 14

Movement	EB	EB	EB	EB	WB	WB	WB	WB	NB	NB	SB	SB
Directions Served	L	T	T	R	L	T	T	R	LT	R	LT	R
Maximum Queue (ft)	242	281	305	21	57	622	662	355	127	49	95	68
Average Queue (ft)	104	144	153	2	17	315	327	90	50	5	69	25
95th Queue (ft)	199	243	260	12	42	586	604	282	103	29	91	57
Link Distance (ft)		3308	3308			5187	5187		2406		27	27
Upstream Blk Time (%)											69	9
Queuing Penalty (veh)											111	14
Storage Bay Dist (ft)	475			475	450			450		100		
Storage Blk Time (%)						4	5		2			
Queuing Penalty (veh)						1	12		0			

Intersection: 40: 10th Avenue & US 14

Movement	EB	EB	EB	EB	WB	WB	WB	WB	NB	NB	SB	SB
Directions Served	L	T	T	R	L	T	T	R	LT	R	L	LT
Maximum Queue (ft)	80	389	412	14	41	632	628	320	231	86	156	202
Average Queue (ft)	27	201	207	2	8	373	385	59	127	4	75	110
95th Queue (ft)	65	366	375	9	28	586	599	208	210	37	133	169
Link Distance (ft)		5187	5187			2001	2001		2853			2081
Upstream Blk Time (%)												
Queuing Penalty (veh)												
Storage Bay Dist (ft)	500			500	525			525		75	180	
Storage Blk Time (%)						3	3		31		0	1
Queuing Penalty (veh)						0	10		1		0	2

Intersection: 40: 10th Avenue & US 14

Movement	SB
Directions Served	R
Maximum Queue (ft)	102
Average Queue (ft)	37
95th Queue (ft)	81
Link Distance (ft)	
Upstream Blk Time (%)	
Queuing Penalty (veh)	
Storage Bay Dist (ft)	180
Storage Blk Time (%)	
Queuing Penalty (veh)	

Intersection: 45: US 14 & CR 3

Movement	WB	WB	NB	SB
Directions Served	L	R	LT	TR
Maximum Queue (ft)	12	4	54	56
Average Queue (ft)	0	0	19	20
95th Queue (ft)	6	3	49	42
Link Distance (ft)			33	1474
Upstream Blk Time (%)			12	
Queuing Penalty (veh)			3	
Storage Bay Dist (ft)	540	500		
Storage Blk Time (%)				
Queuing Penalty (veh)				

Intersection: 50: CR 3 & US 14

Movement	EB	NB	SB
Directions Served	L	TR	LT
Maximum Queue (ft)	5	35	64
Average Queue (ft)	0	13	28
95th Queue (ft)	4	30	59
Link Distance (ft)		2264	33
Upstream Blk Time (%)			16
Queuing Penalty (veh)			12
Storage Bay Dist (ft)	515		
Storage Blk Time (%)			
Queuing Penalty (veh)			

Intersection: 55: US 14 & CR 104

Movement	WB	NB	SB
Directions Served	R	LT	TR
Maximum Queue (ft)	16	85	340
Average Queue (ft)	1	42	169
95th Queue (ft)	10	85	359
Link Distance (ft)		49	1298
Upstream Blk Time (%)		19	
Queuing Penalty (veh)		13	
Storage Bay Dist (ft)	450		
Storage Blk Time (%)			
Queuing Penalty (veh)			

Intersection: 60: CR 104 & US 14

Movement	EB	NB	SB
Directions Served	L	TR	LT
Maximum Queue (ft)	8	54	70
Average Queue (ft)	0	7	26
95th Queue (ft)	4	29	59
Link Distance (ft)		1138	49
Upstream Blk Time (%)			3
Queuing Penalty (veh)			2
Storage Bay Dist (ft)	700		
Storage Blk Time (%)			
Queuing Penalty (veh)			

Intersection: 65: US 14

Movement	NB
Directions Served	L
Maximum Queue (ft)	59
Average Queue (ft)	19
95th Queue (ft)	49
Link Distance (ft)	58
Upstream Blk Time (%)	1
Queuing Penalty (veh)	0
Storage Bay Dist (ft)	
Storage Blk Time (%)	
Queuing Penalty (veh)	

Intersection: 70: 7th Street & US 14

Movement	NB	SB
Directions Served	TR	T
Maximum Queue (ft)	75	70
Average Queue (ft)	30	21
95th Queue (ft)	59	54
Link Distance (ft)	1327	58
Upstream Blk Time (%)		1
Queuing Penalty (veh)		0
Storage Bay Dist (ft)		
Storage Blk Time (%)		
Queuing Penalty (veh)		

Network Summary

Network wide Queuing Penalty: 231

Map - 11722 - US 14 Corridor Analysis
Volumes

11/03/2020

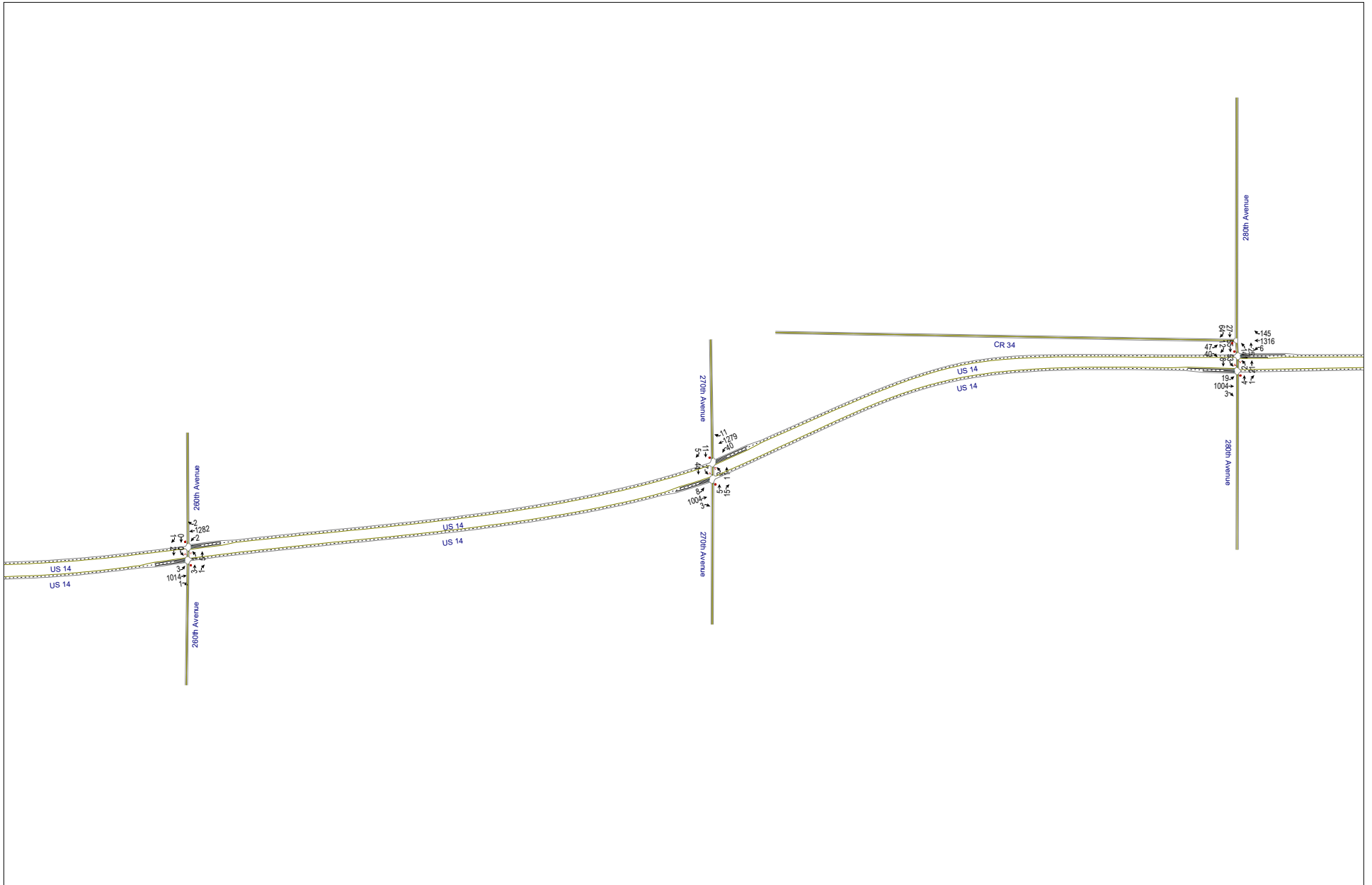

Map - 11722 - US 14 Corridor Analysis
Volumes

11/03/2020

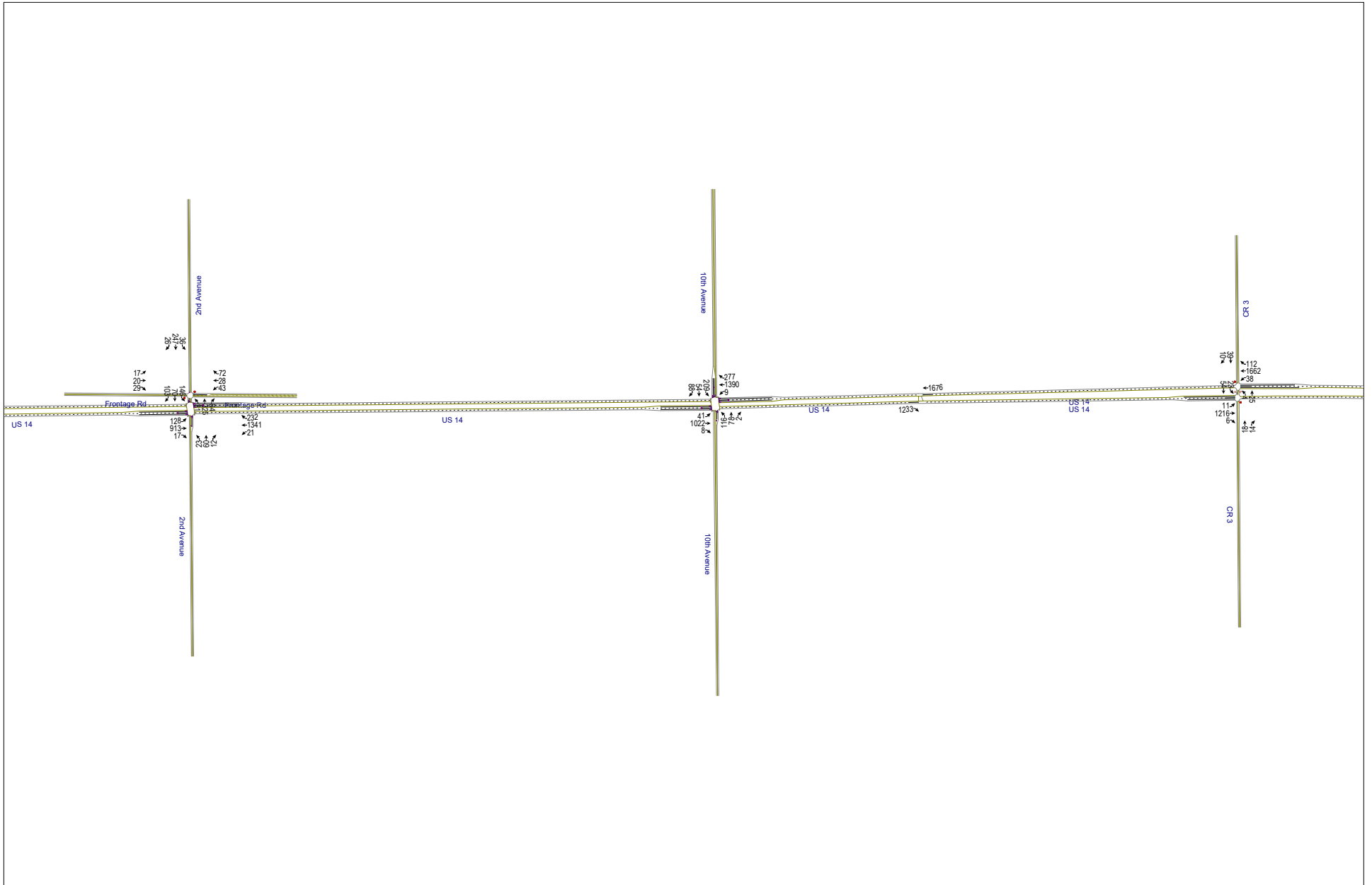

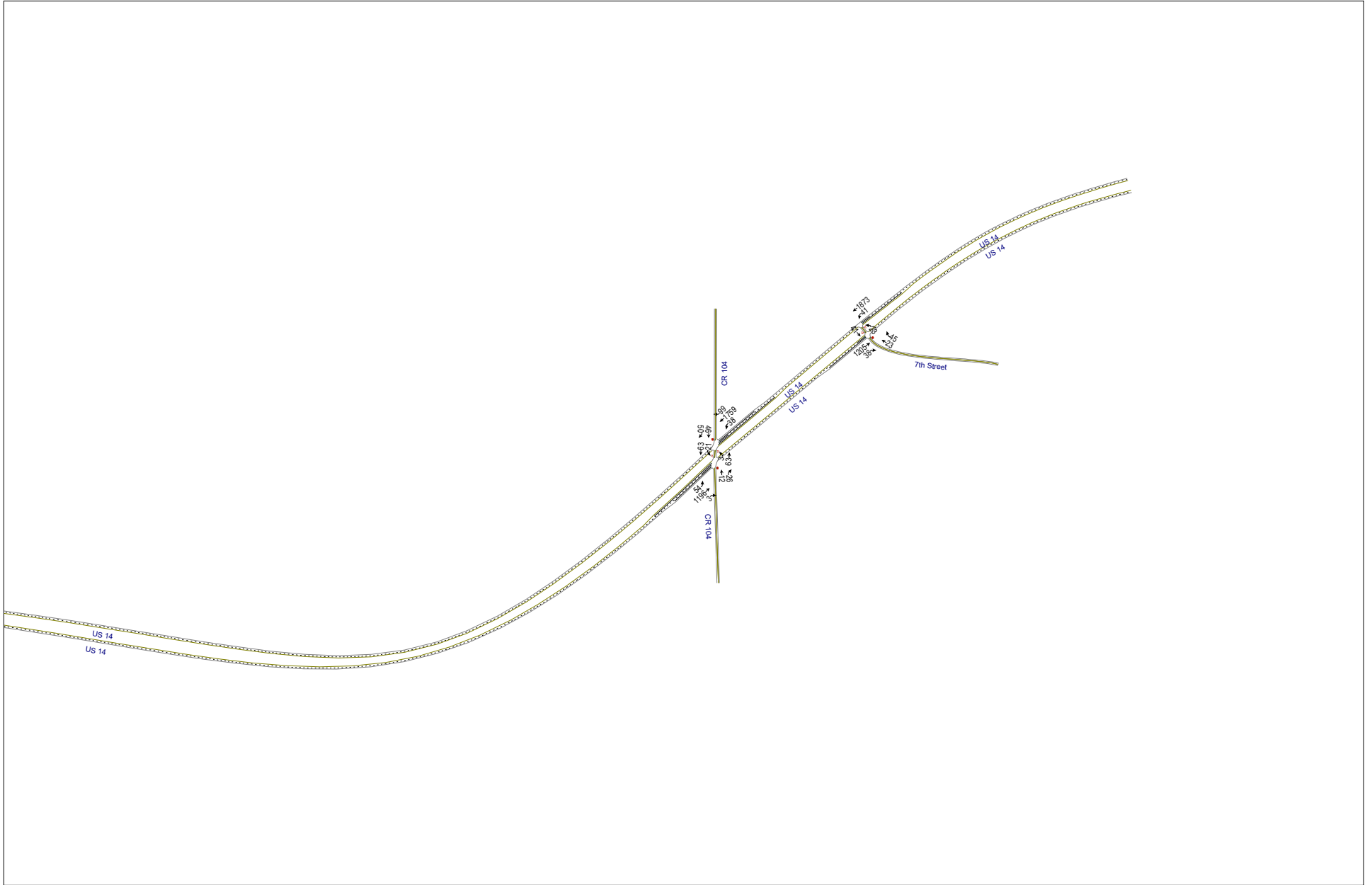

5: US 14 & 270th Avenue Performance by approach

Approach	WB	NB	SB	All
Denied Del/Veh (s)	0.0	0.0	0.1	0.0
Total Del/Veh (s)	5.7	8.1	14.0	6.2

7: US 14 Performance by approach

Approach	WB	NE	All
Denied Del/Veh (s)	0.0	0.0	0.0
Total Del/Veh (s)	7.3	6.0	6.5

10: 270th Avenue & US 14 Performance by approach

Approach	EB	NB	SB	All
Denied Del/Veh (s)	0.0	0.2	0.0	0.0
Total Del/Veh (s)	5.9	25.3	16.3	7.3

15: 280th Avenue & CR 34 Performance by approach

Approach	EB	NB	SB	All
Denied Del/Veh (s)	0.2	0.0	0.2	0.1
Total Del/Veh (s)	5.2	2.3	2.3	3.4

20: US 14 & 280th Avenue Performance by approach

Approach	WB	NB	SB	All
Denied Del/Veh (s)	0.0	0.0	0.0	0.0
Total Del/Veh (s)	5.2	10.6	34.4	12.0

21: US 14 Performance by approach

Approach	EB	WB	All
Denied Del/Veh (s)	0.0	0.0	0.0
Total Del/Veh (s)	16.2	3.7	12.4

25: 280th Avenue & US 14 Performance by approach

Approach	EB	NB	SB	All
Denied Del/Veh (s)	0.0	0.1	0.0	0.0
Total Del/Veh (s)	7.7	21.9	19.8	9.4

30: 2nd Avenue & Frontage Rd Performance by approach

Approach	EB	WB	NB	SB	All
Denied Del/Veh (s)	0.1	1.1	0.0	0.5	0.3
Total Del/Veh (s)	48.5	26.5	6.3	7.8	11.5

33: US 14 & 260th Avenue Performance by approach

Approach	WB	NB	SB	All
Denied Del/Veh (s)	0.0	0.0	0.1	0.0
Total Del/Veh (s)	4.7	5.7	9.7	4.8

34: 260th Avenue & US 14 Performance by approach

Approach	EB	NB	SB	All
Denied Del/Veh (s)	0.3	0.1	0.0	0.3
Total Del/Veh (s)	1.8	11.9	13.1	2.0

35: 2nd Avenue & US 14 Performance by approach

Approach	EB	WB	NB	SB	All
Denied Del/Veh (s)	0.0	0.0	0.8	0.6	0.1
Total Del/Veh (s)	50.2	44.9	47.0	85.2	54.7

40: 10th Avenue & US 14 Performance by approach

Approach	EB	WB	NB	SB	All
Denied Del/Veh (s)	0.0	0.0	0.4	1.0	0.2
Total Del/Veh (s)	172.6	40.6	103.7	116.3	123.3

45: US 14 & CR 3 Performance by approach

Approach	WB	NB	SB	All
Denied Del/Veh (s)	0.0	0.0	0.2	0.0
Total Del/Veh (s)	12.5	7.5	306.0	47.6

50: CR 3 & US 14 Performance by approach

Approach	EB	NB	SB	All
Denied Del/Veh (s)	0.0	0.2	0.9	0.1
Total Del/Veh (s)	7.3	429.2	59.3	29.1

55: US 14 & CR 104 Performance by approach

Approach	WB	NB	SB	All
Denied Del/Veh (s)	0.0	0.0	40.8	7.0
Total Del/Veh (s)	2.8	16.5	441.1	77.7

60: CR 104 & US 14 Performance by approach

Approach	EB	NB	SB	All
Denied Del/Veh (s)	0.0	6.3	0.0	0.3
Total Del/Veh (s)	20.1	715.1	113.2	49.7

65: US 14 Performance by approach

Approach	WB	NB	All
Denied Del/Veh (s)	0.2	0.0	0.2
Total Del/Veh (s)	1.7	8.1	2.1

70: 7th Street & US 14 Performance by approach

Approach	EB	NB	SB	All
Denied Del/Veh (s)	0.0	0.2	0.0	0.0
Total Del/Veh (s)	4.1	211.0	34.8	16.7

Total Network Performance

Denied Del/Veh (s)	2.3
Total Del/Veh (s)	188.6

Intersection: 5: US 14 & 270th Avenue

Movement	NB	SB
Directions Served	LT	TR
Maximum Queue (ft)	47	63
Average Queue (ft)	13	17
95th Queue (ft)	40	40
Link Distance (ft)	77	1184
Upstream Blk Time (%)		
Queuing Penalty (veh)		
Storage Bay Dist (ft)		
Storage Blk Time (%)		
Queuing Penalty (veh)		

Intersection: 7: US 14

Movement
Directions Served
Maximum Queue (ft)
Average Queue (ft)
95th Queue (ft)
Link Distance (ft)
Upstream Blk Time (%)
Queuing Penalty (veh)
Storage Bay Dist (ft)
Storage Blk Time (%)
Queuing Penalty (veh)

Intersection: 10: 270th Avenue & US 14

Movement	NB	SB
Directions Served	TR	LT
Maximum Queue (ft)	94	72
Average Queue (ft)	34	31
95th Queue (ft)	76	63
Link Distance (ft)	1408	77
Upstream Blk Time (%)		0
Queuing Penalty (veh)		0
Storage Bay Dist (ft)		
Storage Blk Time (%)		
Queuing Penalty (veh)		

Intersection: 15: 280th Avenue & CR 34

Movement	EB	NB
Directions Served	LR	LT
Maximum Queue (ft)	86	50
Average Queue (ft)	41	9
95th Queue (ft)	66	35
Link Distance (ft)	4604	1040
Upstream Blk Time (%)		
Queuing Penalty (veh)		
Storage Bay Dist (ft)		
Storage Blk Time (%)		
Queuing Penalty (veh)		

Intersection: 20: US 14 & 280th Avenue

Movement	WB	WB	NB	SB
Directions Served	L	R	LT	TR
Maximum Queue (ft)	10	15	90	312
Average Queue (ft)	0	1	41	121
95th Queue (ft)	4	10	80	261
Link Distance (ft)			65	1040
Upstream Blk Time (%)			4	
Queuing Penalty (veh)			5	
Storage Bay Dist (ft)	275	450		
Storage Blk Time (%)				
Queuing Penalty (veh)				

Intersection: 21: US 14

Movement
Directions Served
Maximum Queue (ft)
Average Queue (ft)
95th Queue (ft)
Link Distance (ft)
Upstream Blk Time (%)
Queuing Penalty (veh)
Storage Bay Dist (ft)
Storage Blk Time (%)
Queuing Penalty (veh)

Intersection: 25: 280th Avenue & US 14

Movement	EB	EB	NB	SB
Directions Served	L	T	TR	LT
Maximum Queue (ft)	34	17	38	105
Average Queue (ft)	2	1	11	77
95th Queue (ft)	17	10	29	112
Link Distance (ft)		5443	1754	65
Upstream Blk Time (%)				22
Queuing Penalty (veh)				52
Storage Bay Dist (ft)	450			
Storage Blk Time (%)				
Queuing Penalty (veh)				

Intersection: 30: 2nd Avenue & Frontage Rd

Movement	EB	WB	WB	NB	SB
Directions Served	LTR	L	TR	LTR	LTR
Maximum Queue (ft)	182	83	138	308	314
Average Queue (ft)	60	30	54	58	67
95th Queue (ft)	170	76	113	247	245
Link Distance (ft)	1224		1042	717	1932
Upstream Blk Time (%)				0	
Queuing Penalty (veh)				0	
Storage Bay Dist (ft)		140			
Storage Blk Time (%)		1	2		
Queuing Penalty (veh)		1	1		

Intersection: 33: US 14 & 260th Avenue

Movement	NB	SB
Directions Served	LT	TR
Maximum Queue (ft)	34	26
Average Queue (ft)	6	9
95th Queue (ft)	26	27
Link Distance (ft)	48	1107
Upstream Blk Time (%)	0	
Queuing Penalty (veh)	0	
Storage Bay Dist (ft)		
Storage Blk Time (%)		
Queuing Penalty (veh)		

Intersection: 34: 260th Avenue & US 14

Movement	NB	SB
Directions Served	TR	LT
Maximum Queue (ft)	40	38
Average Queue (ft)	11	9
95th Queue (ft)	33	32
Link Distance (ft)	1213	48
Upstream Blk Time (%)		0
Queuing Penalty (veh)		0
Storage Bay Dist (ft)		
Storage Blk Time (%)		
Queuing Penalty (veh)		

Intersection: 35: 2nd Avenue & US 14

Movement	EB	EB	EB	EB	WB	WB	WB	WB	NB	NB	SB	SB
Directions Served	L	T	T	R	L	T	T	R	LT	R	LT	R
Maximum Queue (ft)	561	705	667	155	100	544	548	276	236	133	737	280
Average Queue (ft)	321	377	381	13	24	192	198	65	88	19	480	75
95th Queue (ft)	506	641	628	104	69	461	461	185	186	71	792	221
Link Distance (ft)		3308	3308			5187	5187		2406		717	717
Upstream Blk Time (%)												7
Queuing Penalty (veh)												20
Storage Bay Dist (ft)	475			475	450			450		100		
Storage Blk Time (%)	2	5	6			3	3		12			
Queuing Penalty (veh)	11	13	3			1	9		4			

Intersection: 40: 10th Avenue & US 14

Movement	EB	EB	EB	EB	WB	WB	WB	WB	NB	NB	SB	SB
Directions Served	L	T	T	R	L	T	T	R	LT	R	L	LT
Maximum Queue (ft)	680	2351	2353	680	49	554	544	91	433	134	300	1428
Average Queue (ft)	183	1360	1382	84	10	271	284	33	206	14	275	738
95th Queue (ft)	596	2444	2472	437	41	487	487	74	365	71	343	1480
Link Distance (ft)		5187	5187			2001	2001		2853			2081
Upstream Blk Time (%)												0
Queuing Penalty (veh)												0
Storage Bay Dist (ft)	500			500	525			525		75	180	
Storage Blk Time (%)		41	44			0	0		54		48	53
Queuing Penalty (veh)		22	13			0	1		8		217	207

Intersection: 40: 10th Avenue & US 14

Movement	SB
Directions Served	R
Maximum Queue (ft)	300
Average Queue (ft)	95
95th Queue (ft)	296
Link Distance (ft)	
Upstream Blk Time (%)	
Queuing Penalty (veh)	
Storage Bay Dist (ft)	180
Storage Blk Time (%)	
Queuing Penalty (veh)	

Intersection: 45: US 14 & CR 3

Movement	WB	WB	WB	NB	SB
Directions Served	L	T	T	LT	TR
Maximum Queue (ft)	60	32	19	66	761
Average Queue (ft)	17	1	1	32	340
95th Queue (ft)	48	18	14	59	724
Link Distance (ft)		13786	13786	33	1474
Upstream Blk Time (%)				13	
Queuing Penalty (veh)				14	
Storage Bay Dist (ft)	540				
Storage Blk Time (%)					
Queuing Penalty (veh)					

Intersection: 50: CR 3 & US 14

Movement	EB	EB	EB	NB	SB
Directions Served	L	T	R	TR	LT
Maximum Queue (ft)	9	4	10	665	87
Average Queue (ft)	0	0	0	331	62
95th Queue (ft)	5	3	6	757	86
Link Distance (ft)		3136		2264	33
Upstream Blk Time (%)					84
Queuing Penalty (veh)					110
Storage Bay Dist (ft)	515		475		
Storage Blk Time (%)					
Queuing Penalty (veh)					

Intersection: 55: US 14 & CR 104

Movement	WB	WB	WB	NB	SB
Directions Served	L	T	R	LT	TR
Maximum Queue (ft)	17	5	49	94	1282
Average Queue (ft)	1	0	4	63	712
95th Queue (ft)	9	4	23	99	1486
Link Distance (ft)		1793		49	1298
Upstream Blk Time (%)				20	21
Queuing Penalty (veh)				56	0
Storage Bay Dist (ft)	700		450		
Storage Blk Time (%)					
Queuing Penalty (veh)					

Intersection: 60: CR 104 & US 14

Movement	EB	NB	SB
Directions Served	L	TR	LT
Maximum Queue (ft)	102	900	89
Average Queue (ft)	6	430	69
95th Queue (ft)	45	940	100
Link Distance (ft)		1138	49
Upstream Blk Time (%)		3	58
Queuing Penalty (veh)		0	67
Storage Bay Dist (ft)	700		
Storage Blk Time (%)			
Queuing Penalty (veh)			

Intersection: 65: US 14

Movement	WB	NB
Directions Served	L	L
Maximum Queue (ft)	5	68
Average Queue (ft)	0	28
95th Queue (ft)	4	57
Link Distance (ft)		58
Upstream Blk Time (%)		1
Queuing Penalty (veh)		1
Storage Bay Dist (ft)	500	
Storage Blk Time (%)		
Queuing Penalty (veh)		

Intersection: 70: 7th Street & US 14

Movement	EB	NB	SB
Directions Served	R	TR	T
Maximum Queue (ft)	8	409	82
Average Queue (ft)	0	211	33
95th Queue (ft)	4	530	66
Link Distance (ft)		1327	58
Upstream Blk Time (%)			6
Queuing Penalty (veh)			2
Storage Bay Dist (ft)	475		
Storage Blk Time (%)			
Queuing Penalty (veh)			

Network Summary

Network wide Queuing Penalty: 838

Map - 11722 - US 14 Corridor Analysis
Volumes

11/03/2020

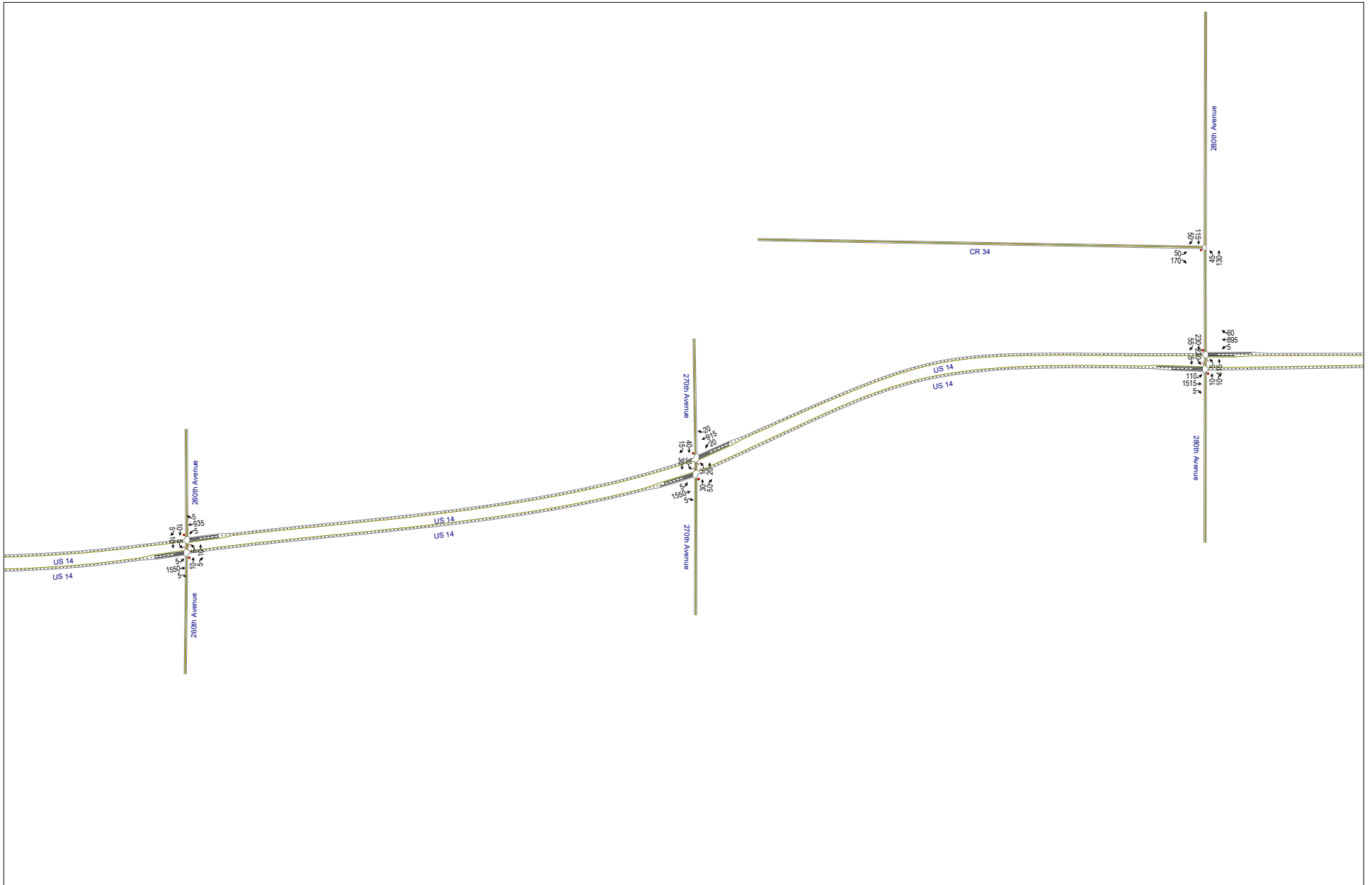

Map - 11722 - US 14 Corridor Analysis
Volumes

11/03/2020

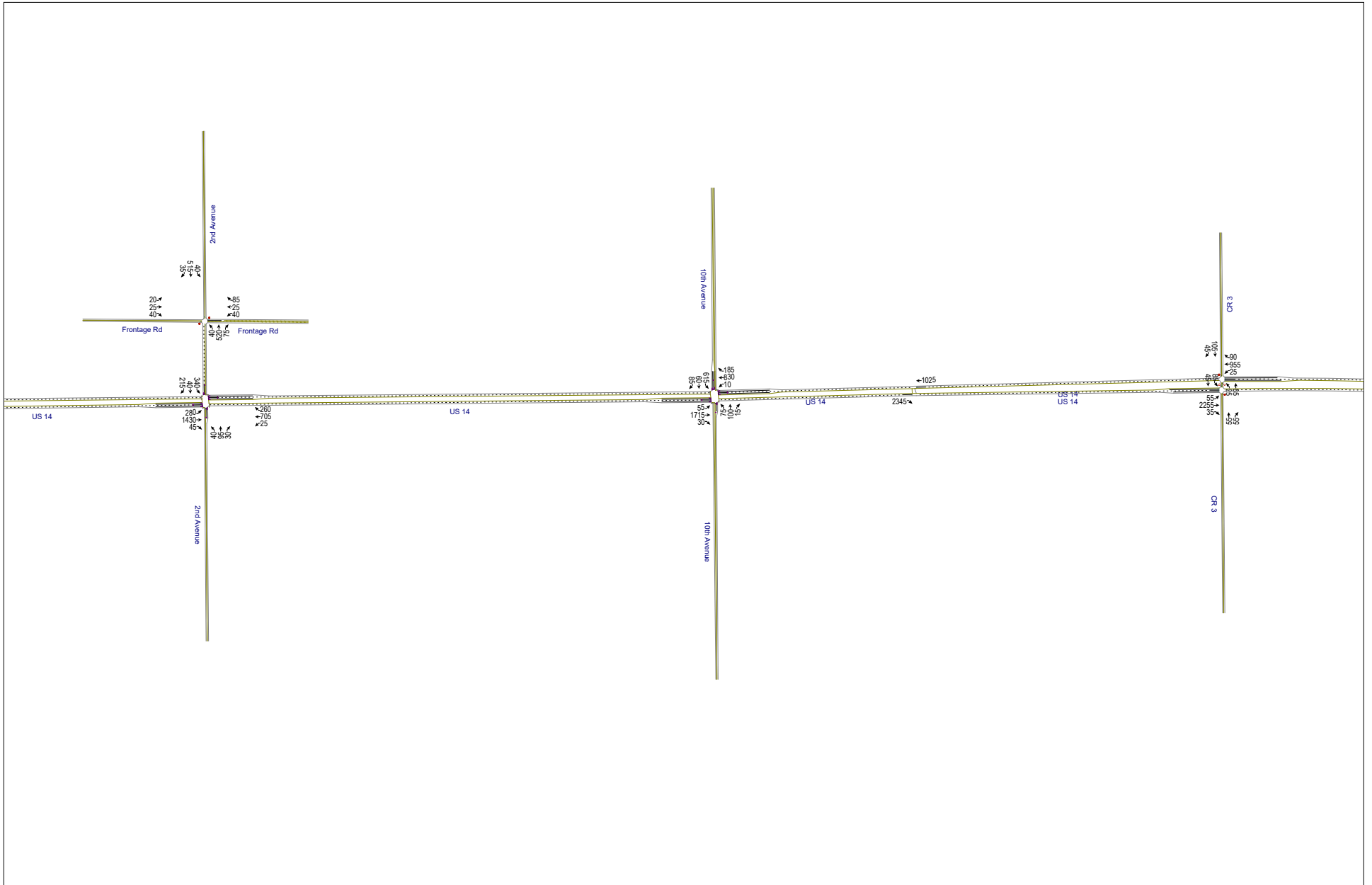

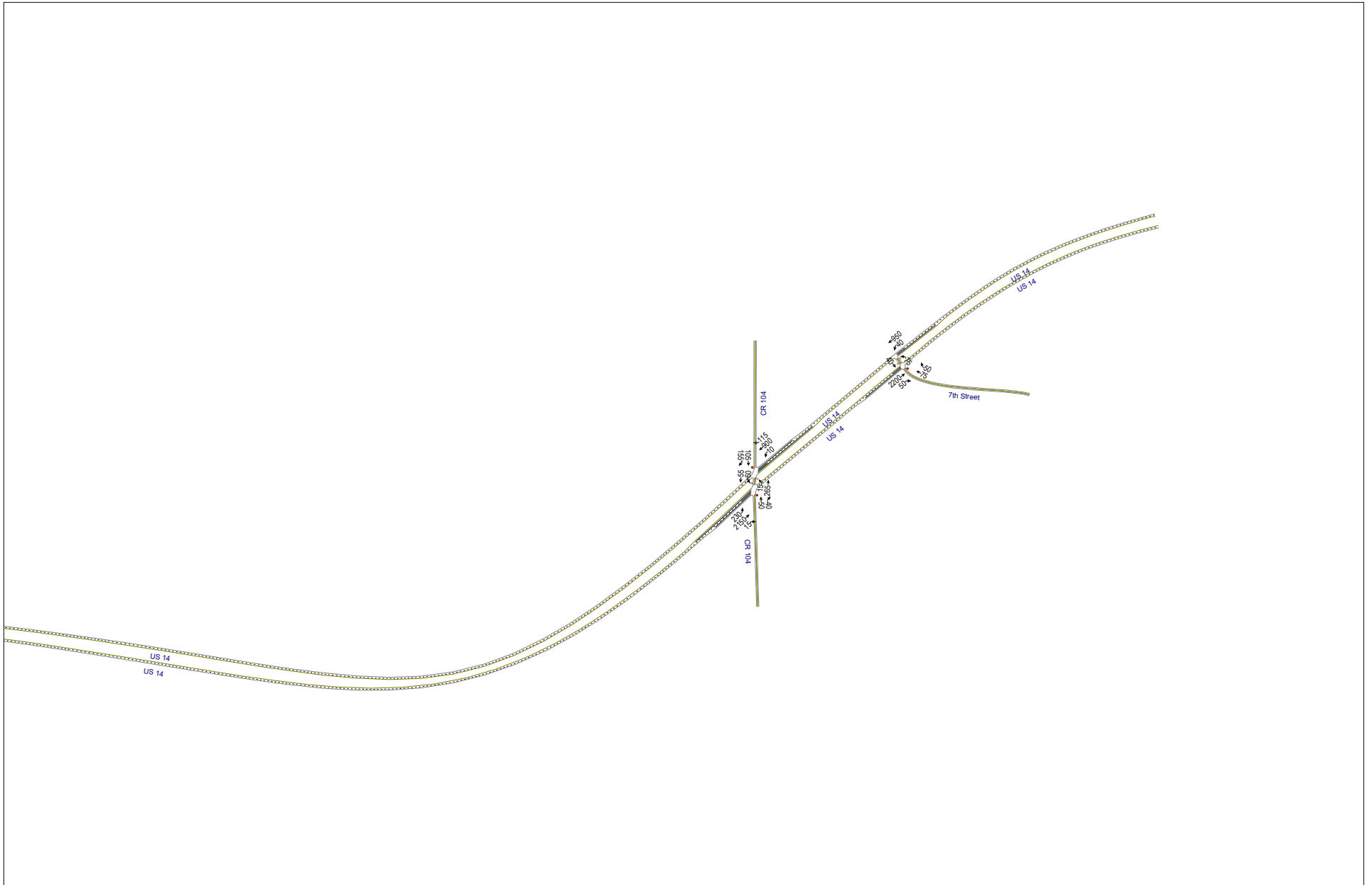

5: US 14 & 270th Avenue Performance by approach

Approach	WB	NB	SB	All
Denied Del/Veh (s)	0.0	0.0	0.1	0.0
Total Del/Veh (s)	6.8	20.4	24.9	7.4

7: US 14 Performance by approach

Approach	WB	NE	All
Denied Del/Veh (s)	0.0	0.0	0.0
Total Del/Veh (s)	16.0	4.3	11.4

10: 270th Avenue & US 14 Performance by approach

Approach	EB	NB	SB	All
Denied Del/Veh (s)	0.0	0.1	0.0	0.0
Total Del/Veh (s)	4.4	11.5	9.6	4.9

15: 280th Avenue & CR 34 Performance by approach

Approach	EB	NB	SB	All
Denied Del/Veh (s)	0.1	0.0	0.2	0.1
Total Del/Veh (s)	6.9	4.0	2.0	4.0

20: US 14 & 280th Avenue Performance by approach

Approach	WB	NB	SB	All
Denied Del/Veh (s)	0.0	0.4	0.0	0.0
Total Del/Veh (s)	8.5	34.7	49.1	13.6

21: US 14 Performance by approach

Approach	EB	WB	All
Denied Del/Veh (s)	0.0	0.0	0.0
Total Del/Veh (s)	9.8	6.5	7.9

25: 280th Avenue & US 14 Performance by approach

Approach	EB	NB	SB	All
Denied Del/Veh (s)	0.0	0.1	0.0	0.0
Total Del/Veh (s)	6.7	23.7	11.3	7.3

30: 2nd Avenue & Frontage Rd Performance by approach

Approach	EB	WB	NB	SB	All
Denied Del/Veh (s)	0.2	1.4	0.0	0.5	0.4
Total Del/Veh (s)	117.2	59.5	7.8	18.4	27.4

33: US 14 & 260th Avenue Performance by approach

Approach	WB	NB	SB	All
Denied Del/Veh (s)	0.0	0.0	0.1	0.0
Total Del/Veh (s)	5.8	14.1	16.9	6.0

34: 260th Avenue & US 14 Performance by approach

Approach	EB	NB	SB	All
Denied Del/Veh (s)	0.2	0.1	0.0	0.2
Total Del/Veh (s)	1.5	9.2	11.2	1.7

35: 2nd Avenue & US 14 Performance by approach

Approach	EB	WB	NB	SB	All
Denied Del/Veh (s)	0.0	0.0	0.6	0.0	0.0
Total Del/Veh (s)	43.2	76.5	55.7	123.8	73.2

40: 10th Avenue & US 14 Performance by approach

Approach	EB	WB	NB	SB	All
Denied Del/Veh (s)	0.0	0.0	0.4	1.0	0.2
Total Del/Veh (s)	47.2	74.5	101.3	81.1	68.4

45: US 14 & CR 3 Performance by approach

Approach	WB	NB	SB	All
Denied Del/Veh (s)	0.0	0.0	0.2	0.0
Total Del/Veh (s)	20.9	49.5	352.5	36.8

50: CR 3 & US 14 Performance by approach

Approach	EB	NB	SB	All
Denied Del/Veh (s)	0.0	0.1	0.0	0.0
Total Del/Veh (s)	10.2	71.9	19.3	13.7

55: US 14 & CR 104 Performance by approach

Approach	WB	NB	SB	All
Denied Del/Veh (s)	0.0	0.0	1081.7	87.8
Total Del/Veh (s)	5.3	335.4	2259.3	88.4

60: CR 104 & US 14 Performance by approach

Approach	EB	NB	SB	All
Denied Del/Veh (s)	0.0	292.6	1.9	15.1
Total Del/Veh (s)	162.9	2426.2	59.8	232.8

65: US 14 Performance by approach

Approach	WB	NB	All
Denied Del/Veh (s)	0.8	0.0	0.8
Total Del/Veh (s)	6.4	148.9	8.9

70: 7th Street & US 14 Performance by approach

Approach	EB	NB	SB	All
Denied Del/Veh (s)	0.0	0.2	0.0	0.0
Total Del/Veh (s)	3.5	163.1	12.8	18.6

Total Network Performance

Denied Del/Veh (s)	39.6
Total Del/Veh (s)	212.1

Intersection: 5: US 14 & 270th Avenue

Movement	NB	SB
Directions Served	LT	TR
Maximum Queue (ft)	60	60
Average Queue (ft)	18	18
95th Queue (ft)	48	45
Link Distance (ft)	77	1184
Upstream Blk Time (%)	0	
Queuing Penalty (veh)	0	
Storage Bay Dist (ft)		
Storage Blk Time (%)		
Queuing Penalty (veh)		

Intersection: 7: US 14

Movement	WB
Directions Served	T
Maximum Queue (ft)	667
Average Queue (ft)	24
95th Queue (ft)	487
Link Distance (ft)	3308
Upstream Blk Time (%)	
Queuing Penalty (veh)	
Storage Bay Dist (ft)	
Storage Blk Time (%)	
Queuing Penalty (veh)	

Intersection: 10: 270th Avenue & US 14

Movement	NB	SB
Directions Served	TR	LT
Maximum Queue (ft)	46	64
Average Queue (ft)	12	29
95th Queue (ft)	29	58
Link Distance (ft)	1408	77
Upstream Blk Time (%)		0
Queuing Penalty (veh)		0
Storage Bay Dist (ft)		
Storage Blk Time (%)		
Queuing Penalty (veh)		

Intersection: 15: 280th Avenue & CR 34

Movement	EB	NB	SB
Directions Served	LR	LT	TR
Maximum Queue (ft)	87	79	17
Average Queue (ft)	40	31	1
95th Queue (ft)	69	68	7
Link Distance (ft)	4604	1091	2412
Upstream Blk Time (%)			
Queuing Penalty (veh)			
Storage Bay Dist (ft)			
Storage Blk Time (%)			
Queuing Penalty (veh)			

Intersection: 20: US 14 & 280th Avenue

Movement	WB	WB	NB	SB
Directions Served	L	R	LT	TR
Maximum Queue (ft)	10	50	108	213
Average Queue (ft)	0	5	78	100
95th Queue (ft)	8	27	116	189
Link Distance (ft)			65	1091
Upstream Blk Time (%)			34	
Queuing Penalty (veh)			58	
Storage Bay Dist (ft)	275	450		
Storage Blk Time (%)				
Queuing Penalty (veh)				

Intersection: 21: US 14

Movement
Directions Served
Maximum Queue (ft)
Average Queue (ft)
95th Queue (ft)
Link Distance (ft)
Upstream Blk Time (%)
Queuing Penalty (veh)
Storage Bay Dist (ft)
Storage Blk Time (%)
Queuing Penalty (veh)

Intersection: 25: 280th Avenue & US 14

Movement	EB	EB	NB	SB
Directions Served	L	T	TR	LT
Maximum Queue (ft)	151	4	45	97
Average Queue (ft)	38	0	10	34
95th Queue (ft)	114	3	30	77
Link Distance (ft)		5443	1754	65
Upstream Blk Time (%)				2
Queuing Penalty (veh)				2
Storage Bay Dist (ft)	450			
Storage Blk Time (%)				
Queuing Penalty (veh)				

Intersection: 30: 2nd Avenue & Frontage Rd

Movement	EB	WB	WB	NB	SB
Directions Served	LTR	L	TR	LTR	LTR
Maximum Queue (ft)	347	159	317	315	570
Average Queue (ft)	123	61	103	73	151
95th Queue (ft)	348	144	264	226	471
Link Distance (ft)	1224		1042	691	1932
Upstream Blk Time (%)					
Queuing Penalty (veh)					
Storage Bay Dist (ft)		140			
Storage Blk Time (%)		2	17		
Queuing Penalty (veh)		3	11		

Intersection: 33: US 14 & 260th Avenue

Movement	NB	SB
Directions Served	LT	TR
Maximum Queue (ft)	55	43
Average Queue (ft)	11	9
95th Queue (ft)	37	29
Link Distance (ft)	48	1107
Upstream Blk Time (%)	1	
Queuing Penalty (veh)	0	
Storage Bay Dist (ft)		
Storage Blk Time (%)		
Queuing Penalty (veh)		

Intersection: 34: 260th Avenue & US 14

Movement	NB	SB
Directions Served	TR	LT
Maximum Queue (ft)	31	46
Average Queue (ft)	9	10
95th Queue (ft)	30	36
Link Distance (ft)	1213	48
Upstream Blk Time (%)		1
Queuing Penalty (veh)		0
Storage Bay Dist (ft)		
Storage Blk Time (%)		
Queuing Penalty (veh)		

Intersection: 35: 2nd Avenue & US 14

Movement	EB	EB	EB	EB	WB	WB	WB	WB	NB	NB	SB	SB
Directions Served	L	T	T	R	L	T	T	R	LT	R	LT	R
Maximum Queue (ft)	370	456	447	35	322	1066	1112	630	317	150	762	531
Average Queue (ft)	200	221	230	7	57	566	607	208	117	22	595	165
95th Queue (ft)	337	442	441	24	226	1093	1137	630	239	95	878	349
Link Distance (ft)		3308	3308			5187	5187		2406		691	691
Upstream Blk Time (%)												22
Queuing Penalty (veh)												66
Storage Bay Dist (ft)	475			475	450			450		100		
Storage Blk Time (%)		0	0			17	19		19			
Queuing Penalty (veh)		0	0			8	61		5			

Intersection: 40: 10th Avenue & US 14

Movement	EB	EB	EB	EB	WB	WB	WB	WB	NB	NB	SB	SB
Directions Served	L	T	T	R	L	T	T	R	LT	R	L	LT
Maximum Queue (ft)	213	637	612	148	428	1332	1346	650	472	135	300	512
Average Queue (ft)	98	266	274	12	47	747	761	327	279	14	198	248
95th Queue (ft)	183	562	570	144	260	1304	1318	804	441	75	313	421
Link Distance (ft)		5187	5187			2001	2001		2853			2081
Upstream Blk Time (%)												
Queuing Penalty (veh)												
Storage Bay Dist (ft)	500			500	525			525		75	180	
Storage Blk Time (%)		2	3			25	27		62		20	30
Queuing Penalty (veh)		2	0			4	92		6		66	78

Intersection: 40: 10th Avenue & US 14

Movement	SB
Directions Served	R
Maximum Queue (ft)	300
Average Queue (ft)	102
95th Queue (ft)	252
Link Distance (ft)	
Upstream Blk Time (%)	
Queuing Penalty (veh)	
Storage Bay Dist (ft)	180
Storage Blk Time (%)	1
Queuing Penalty (veh)	2

Intersection: 45: US 14 & CR 3

Movement	WB	WB	NB	SB
Directions Served	L	R	LT	TR
Maximum Queue (ft)	72	34	74	520
Average Queue (ft)	14	3	54	269
95th Queue (ft)	51	18	78	612
Link Distance (ft)			33	1474
Upstream Blk Time (%)			73	
Queuing Penalty (veh)			81	
Storage Bay Dist (ft)	540	500		
Storage Blk Time (%)				
Queuing Penalty (veh)				

Intersection: 50: CR 3 & US 14

Movement	EB	EB	EB	NB	SB
Directions Served	L	T	R	TR	LT
Maximum Queue (ft)	178	4	8	159	74
Average Queue (ft)	65	0	0	58	49
95th Queue (ft)	200	3	4	140	76
Link Distance (ft)		3136		2264	33
Upstream Blk Time (%)					42
Queuing Penalty (veh)					64
Storage Bay Dist (ft)	515		475		
Storage Blk Time (%)					
Queuing Penalty (veh)					

Intersection: 55: US 14 & CR 104

Movement	WB	WB	WB	NB	SB
Directions Served	L	T	R	LT	TR
Maximum Queue (ft)	77	1	40	104	1317
Average Queue (ft)	12	0	2	78	1235
95th Queue (ft)	75	0	18	94	1543
Link Distance (ft)		1793		49	1298
Upstream Blk Time (%)				99	82
Queuing Penalty (veh)				193	0
Storage Bay Dist (ft)	700		450		
Storage Blk Time (%)					
Queuing Penalty (veh)					

Intersection: 60: CR 104 & US 14

Movement	EB	EB	EB	NB	SB
Directions Served	L	T	T	TR	LT
Maximum Queue (ft)	850	2402	2378	1141	93
Average Queue (ft)	658	1122	1061	790	47
95th Queue (ft)	1105	2561	2526	1407	96
Link Distance (ft)		13696	13696	1138	49
Upstream Blk Time (%)				41	30
Queuing Penalty (veh)				0	48
Storage Bay Dist (ft)	700				
Storage Blk Time (%)	63	5	0		
Queuing Penalty (veh)	409	8	0		

Intersection: 65: US 14

Movement	WB	NB
Directions Served	L	L
Maximum Queue (ft)	5	93
Average Queue (ft)	0	58
95th Queue (ft)	4	101
Link Distance (ft)		58
Upstream Blk Time (%)		40
Queuing Penalty (veh)		18
Storage Bay Dist (ft)	500	
Storage Blk Time (%)		
Queuing Penalty (veh)		

Intersection: 70: 7th Street & US 14

Movement	EB	EB	NB	SB
Directions Served	T	R	TR	T
Maximum Queue (ft)	4	9	529	84
Average Queue (ft)	0	0	187	37
95th Queue (ft)	3	7	504	72
Link Distance (ft)	1907		1327	58
Upstream Blk Time (%)				3
Queuing Penalty (veh)				2
Storage Bay Dist (ft)		475		
Storage Blk Time (%)				
Queuing Penalty (veh)				

Network Summary

Network wide Queuing Penalty: 1292

Map - 11722 - US 14 Corridor Analysis
Volumes

11/03/2020

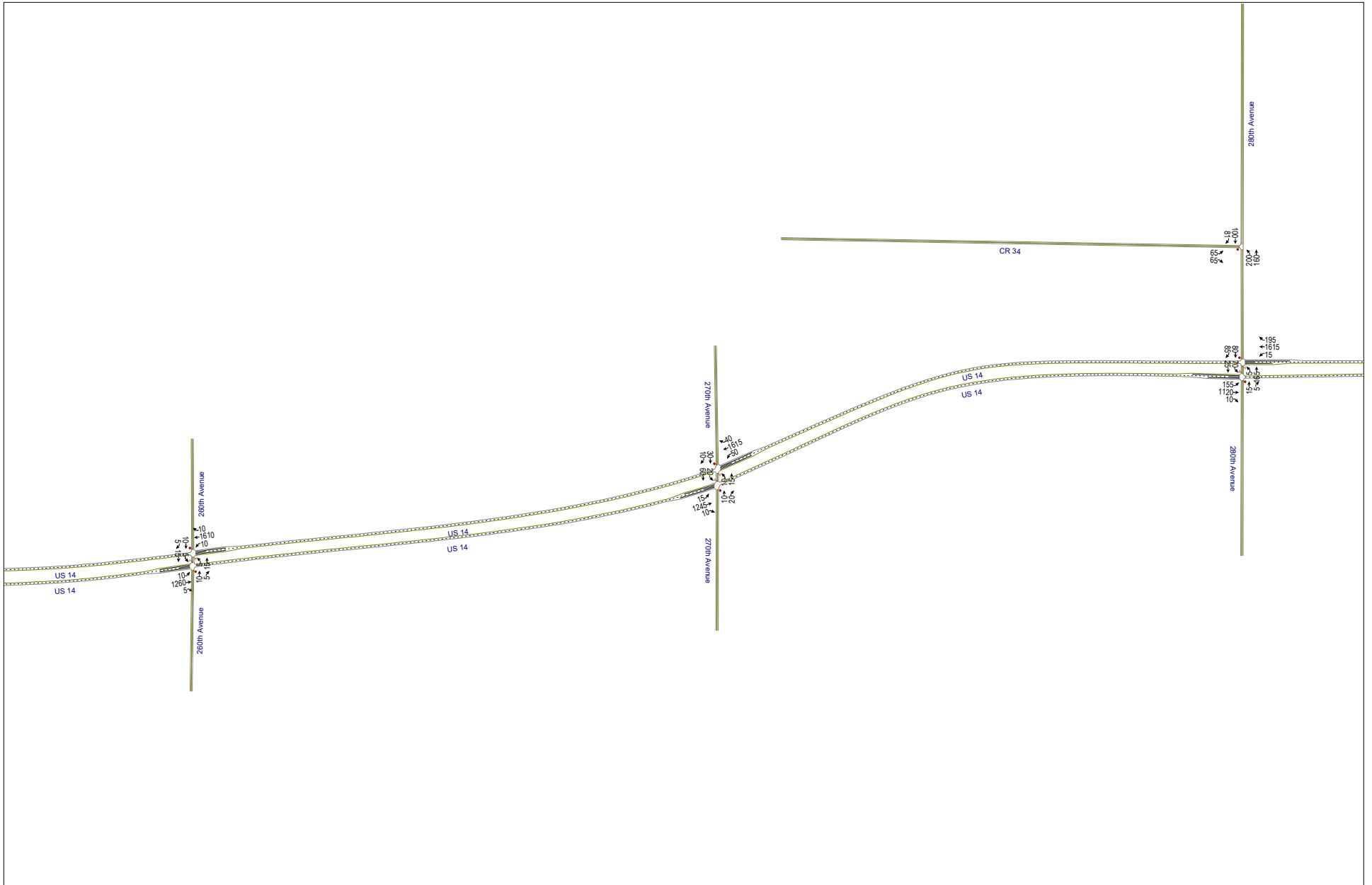

Map - 11722 - US 14 Corridor Analysis
Volumes

11/03/2020

